

## Hydraulic Box Turner BT H

For emptying 600, 800 and 2.000 kg boxes.



Box turner BT H600 for 600 kg boxes.

Hydraulic box turners are available in three different versions, BT 600, BT 800 and BT 2000 for emptying 600, 800 and 2 000 kg boxes respectively. Boxes can be inserted from manual forklifts.

Boxes are emptied by turning them through approx. 135° round an axis 1,2 m above floor level. Box turners are fitted with a safety device

to eliminate the risk of trapping.

When the safety barrier is raised the power supply is cut off.

The Box Turner can be modified for emptying large sacks instead of boxes. The BT 2000 is available in versions to individual specifications depending on box dimensions.



BT H600 with hopper H F1 ME

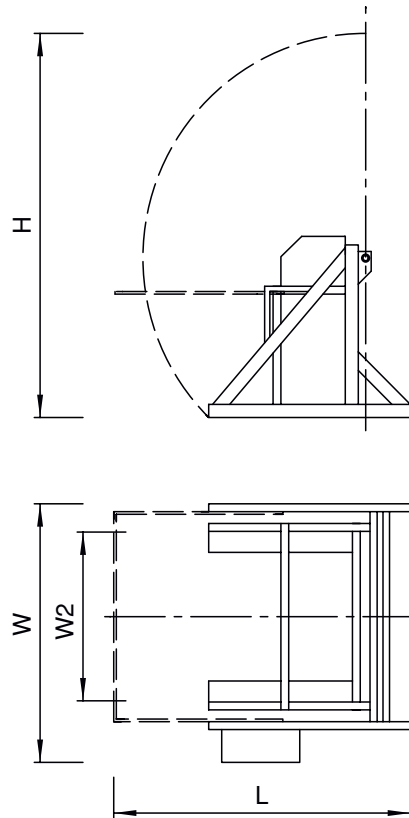

|                             | BT H600   | BT H800      | BT H2000    |
|-----------------------------|---|--------------|-------------|
| Box weight                  | 600 kg  | 800 kg       | 2000 kg     |
| External length (L)         | 2250 mm   | 2250 mm      | * see below |
| External width (W)          | 1900 mm   | 2200 mm      | * see below |
| External height (H)         | 2900 mm   | 2900 mm      | * see below |
| Internal width (w2)         | 1300 mm   | 1600 mm      | * see below |
| Internal depth              | 1050 mm   | 1100 mm      | * see below |
| Internal height, adjustable | 1000–1200 mm                                    | 1000–1300 mm | * see below |
| Pump output                 | 3,0 kW  | 3,0 kW       | 4,2 kW      |
| Drive unit                  | electrically powered hydraulic pump             |              |             |
| Electrical connections      | wired for 3-phase N/PE~, 230/400 V, 50 Hz, 16 A |              |             |

\* to individual specifications depending on box dimensions

Hydraulic box turners are normally mounted next to hoppers into which boxes are to be emptied. Because these box turners are hydraulically operated, they can be installed in buildings with lower roof

clearances than types of box turner that are hopper-mounted. As the box turning frame reaches down to floor level, boxes can be inserted from manual forklifts. Hopper-mounted box turners BT

600, BT 800, BT 2000 and BT 4000 are available for applications where there is sufficient roof clearance and trucks are being used.

Equipment for emptying large sacks with the BT H800  
Available in stainless steel  
Also available for other box dimensions

Återförsäljare: